

The background features a school building with large windows and a prominent clock tower on the right. The clock tower is black with a white face and Roman numerals, topped with a small figure. The name 'SHAKER' is visible above the clock face. An American flag is visible in the upper left. The scene is set against a clear blue sky with some light clouds. A large blue graphic element is on the left side of the image.

North Colonie

CENTRAL SCHOOL DISTRICT

Shaker High School Enrollment Growth

	2013	2023	2025	2030
Grades 9-12 Enrollment	1962	2086	2164	2239

Regional Enrollment Comparison

2013-2014	2022-2023	Difference	Percentage
North Colonie 5347	North Colonie 6185 *	+838	+16%
Niskayuna 4126	Niskayuna 4,314	+188	+5%
Bethlehem 4702	Bethlehem 4,070	-632	-13%
Saratoga Springs City 6562	Saratoga Springs City 5,946	-616	-9%
Ballston Spa 4203	Ballston Spa 3894	-309	-7%
Shenendehowa 9734	Shenendehowa 9,388	-346	-4%
Burnt Hills- Ballston Lake 3179	Burnt Hills- Ballston Lake 3,081	-98	-3%
South Colonie 4861	South Colonie 4,748	-113	-2%
Guilderland 4925	Guilderland 4,853	-72	-1%



Academic Excellence

- Advance academic and extracurricular facilities
- Create modernized learning environments
- Improve infrastructure



Equity

- Foster equity by providing all students with equal access to high-quality educational and extracurricular resources.



Social-Emotional Health

- Create welcoming, functional spaces, from improved classrooms and auditoriums to renovated restrooms and athletic fields, to support the social and emotional well-being and growth of students.

Projects to be Funded Through Our Capital Reserve

Item	Description	Building	Cost
Transfer to Capital Project (Vote May 2024)			
T.1	SHS - Refinish Gymnasium Floor	SHS	\$268,320
T.2	District-Wide Radio Replacements (Equipment Purchase)	DW	\$473,304
T.3	SHS Main Storm Drain Replacement	SHS	\$112,944
T.4.1	Resurface Existing Running Track	SHS	\$625,976
T.4.2	Replace Fencing at Running Track	SHS	\$214,760
T.6	SHS Dover Elevator Upgrades	SHS	\$209,456
T.9	Blue Creek ES Cafeteria Abatement Work	BC	\$585,000
T.12	Loundonville ES Music Room - Lead Abatement Project	LO	\$89,544
T.13	Latham Ridge ES Gymnasium Ventilation Project	LR	\$402,584
T.14	Elementary Gymnasium Equipment Renovations	DW	\$456,040
T.15	Water Heater Replacements - (10 total @ \$10,000 each)	DW	\$178,984
T.16	Add Sound Panels at SG, LR, BC Cafeterias	SG LR BC	\$161,096
T.18	SHS "H" Gym Entry and Site Work	SHS	\$605,000
1.5.4	SHS Single Occupancy Bathrooms - D-Wing - Second Floor	SHS	\$536,536
1.5.5	SHS Single Occupancy Bathrooms - C-Wing - Second Floor	SHS	\$536,536
1.5.10	SHS Single Occupancy Bathrooms - E-Wing - First Floor	SHS	\$249,500
Subtotal:			\$5,705,580

Proposed Capital Project: Scope of Work



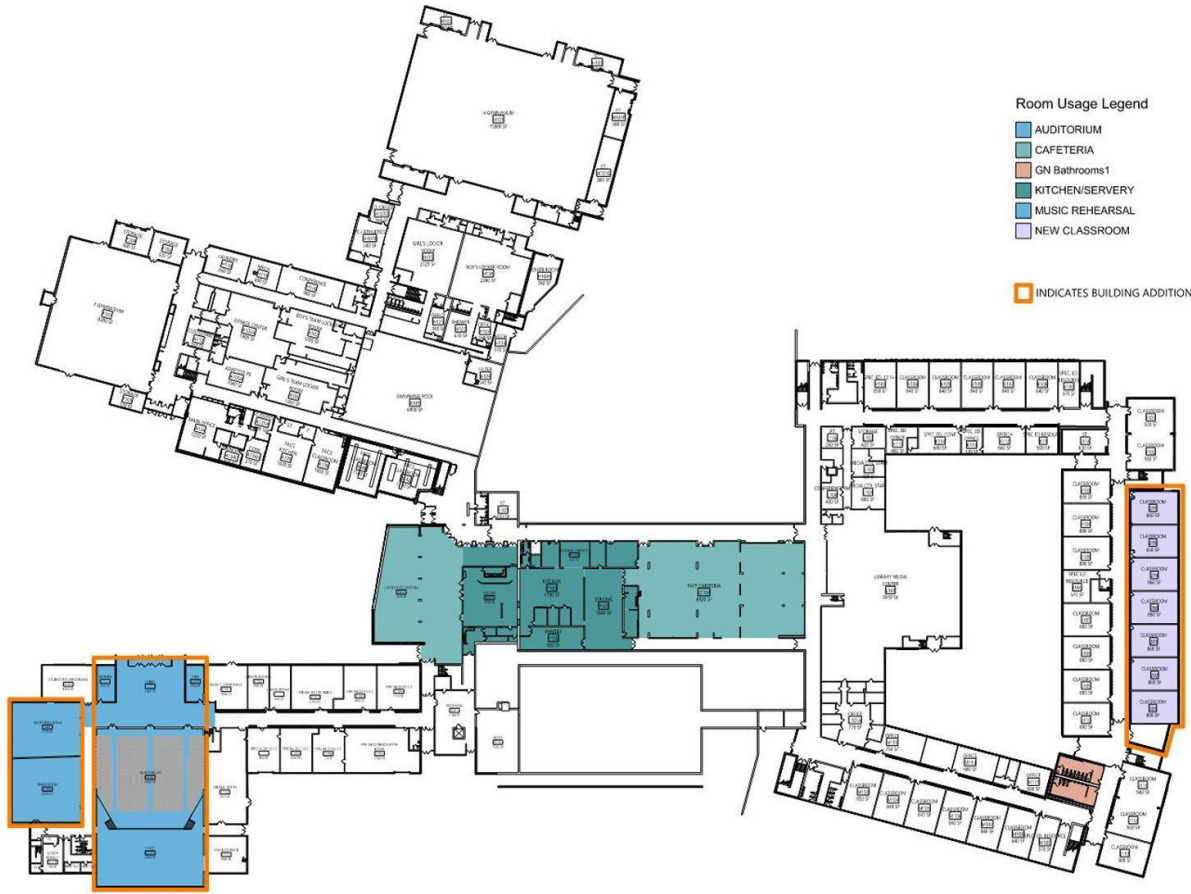

- J-Wing Classroom Addition
- J-Wing Single Occupancy Toilet Renovations
- Kitchen/Cafeteria Renovations
- Auditorium Reconstruction
- Music Rehearsal Space Reconstruction
- G-Wing Single Occupancy Toilet Renovations

1ST FLOOR

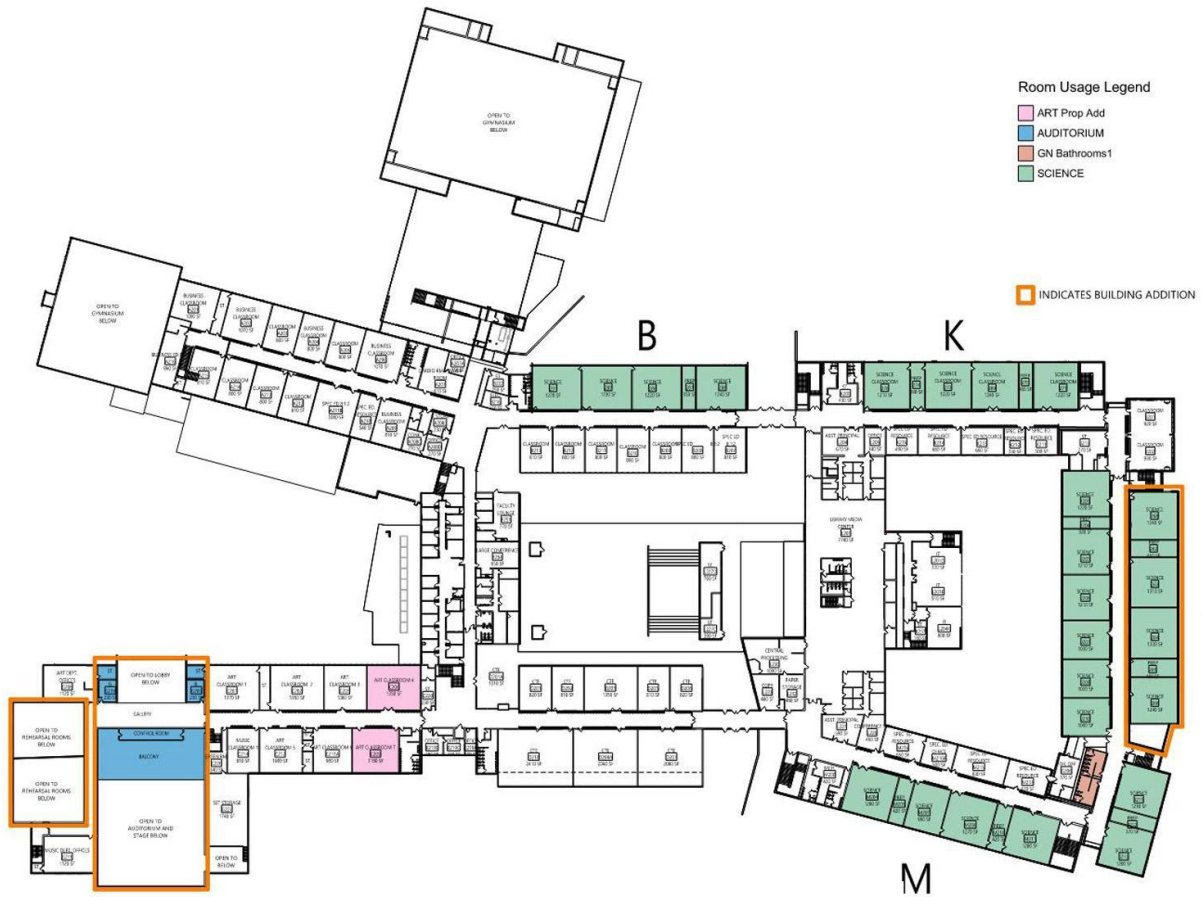

- J-Wing Science Labs Addition
- B, K, J, M Wing Science Renovations
- J-Wing Single Occupancy Toilet Renovations
- Auditorium Balcony
- Art Gallery Renovations
- Misc. Roof Replacement
- Lower Maloy Synthetic Surface
- Walker Field LED Lighting
- LED Entrance Sign
- HVAC Controls

Scope of Work Summary

- 2-Story J-Wing Addition
- New and Renovated Science Labs and General Classrooms
- Kitchen/Cafeteria Renovations
- Single Occupancy Toilet Renovations
- Renovated Auditorium with Balcony for Additional Seating
- Expanded Music Rehearsal Spaces
- Renovated and Expanded Art Gallery
- HVAC Control Systems Upgrade
- Infrastructure Improvements (plumbing, electrical)
- LED Entrance Sign
- Roof Replacements
- Lower Maloy Turf Field
- Walker Field LED Lights

Cost and Tax Impact

Total Project Cost	\$94,137,680
New York State Building Aid (approximately 78%)	\$73,547,527
Taxpayer Share	\$20,590,153

Tax Impact Summary

Estimated tax rate per \$1000 of taxable value is \$1.16

	\$100,000 Assessed Value	\$170,000 Assessed Value	\$300,000 Assessed Value	\$500,000 Assessed Value
Estimated Annual Tax Impact	\$116	\$197	\$348	\$580
Estimated Weekly Tax Impact	\$2.23	\$3.79	\$6.70	\$11.15