

North Colonie Central School District

# Building for the Future

March 5, 2024

CSARCH



# Agenda

- District Survey Results
- Master Plan Review
- Transfer to Capital
- Referendum Scope of Work

## District Survey Results

# All Survey Respondents: Greatest Areas of Concern

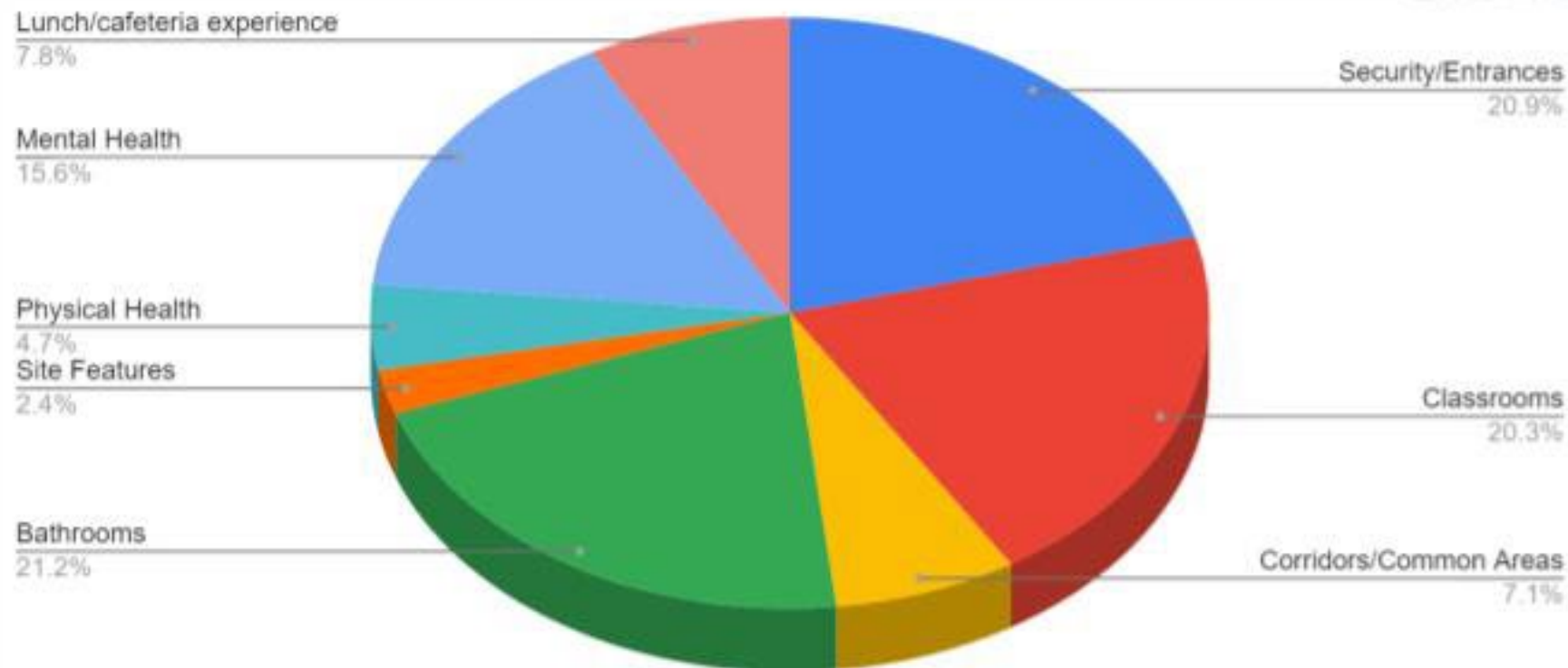

## Sample comments from the top three areas:

**Bathrooms:** Privacy is an issue, need single stalls, better security and ventilation

**Security/Entrances:** Flow in/out for events, cameras in stairwells, and entrances are outdated

**Classrooms:** Outdated, too small, science labs are insufficient, and prefer classrooms organized by subject

# Survey Respondents Familiar with Shaker High School: Greatest Areas of Concern

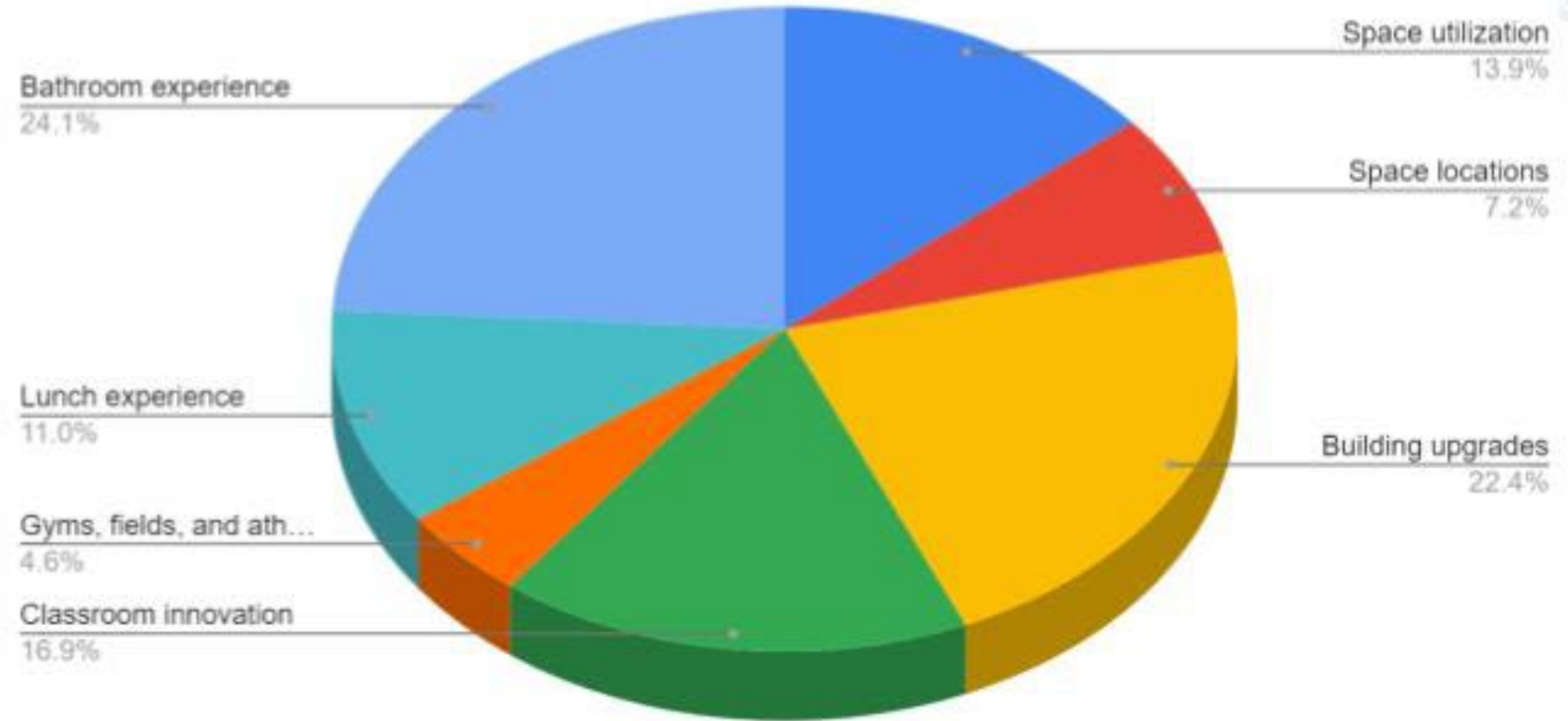

**Sample comments from the top three areas (see previous slide for bathroom concerns):**

**Building Upgrades:** Better lighting, desk/seating upgrades, auditorium and cafeteria space & upgrades, and general facelift to building

**Innovation Classrooms:** More innovation/collaboration spaces, Music/Art/Science upgrades (most frequent responses) and improve technology and equipment

## Master Plan Review

# First Floor – Concept Program Areas

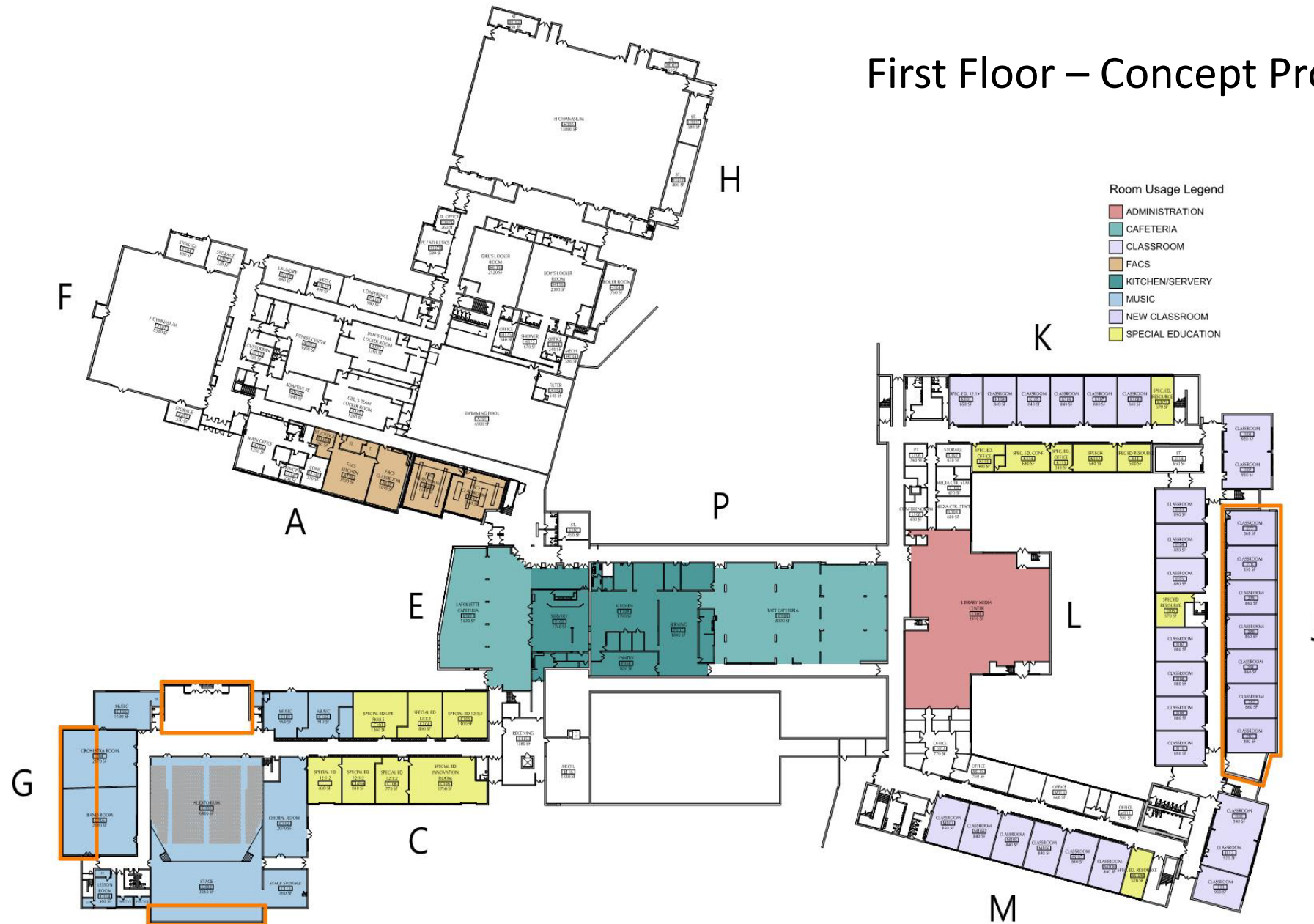

## Second Floor – Concept Program Areas



# First Floor – Addition/Renovation Areas

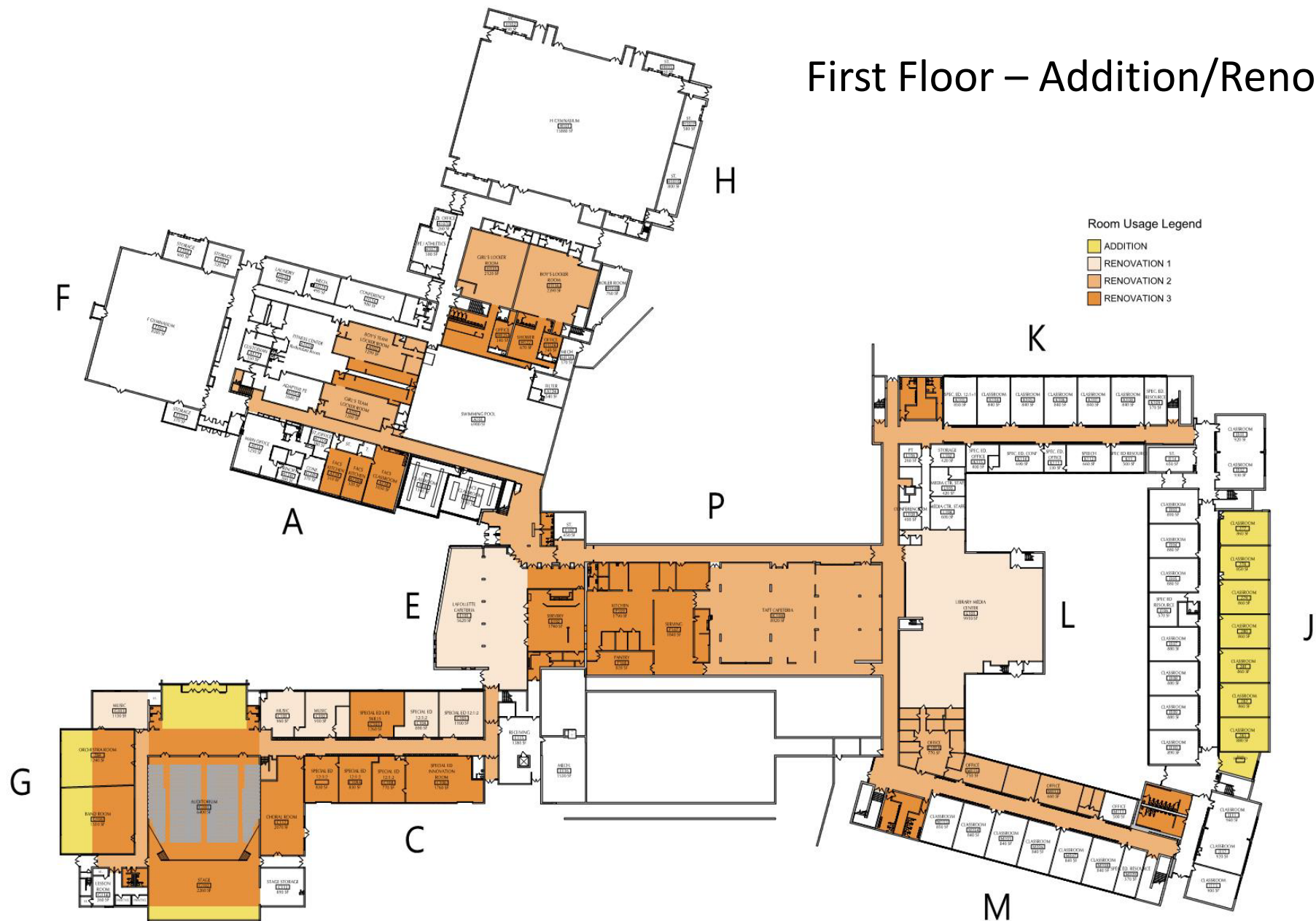

## Second Floor – Addition/Renovation Areas

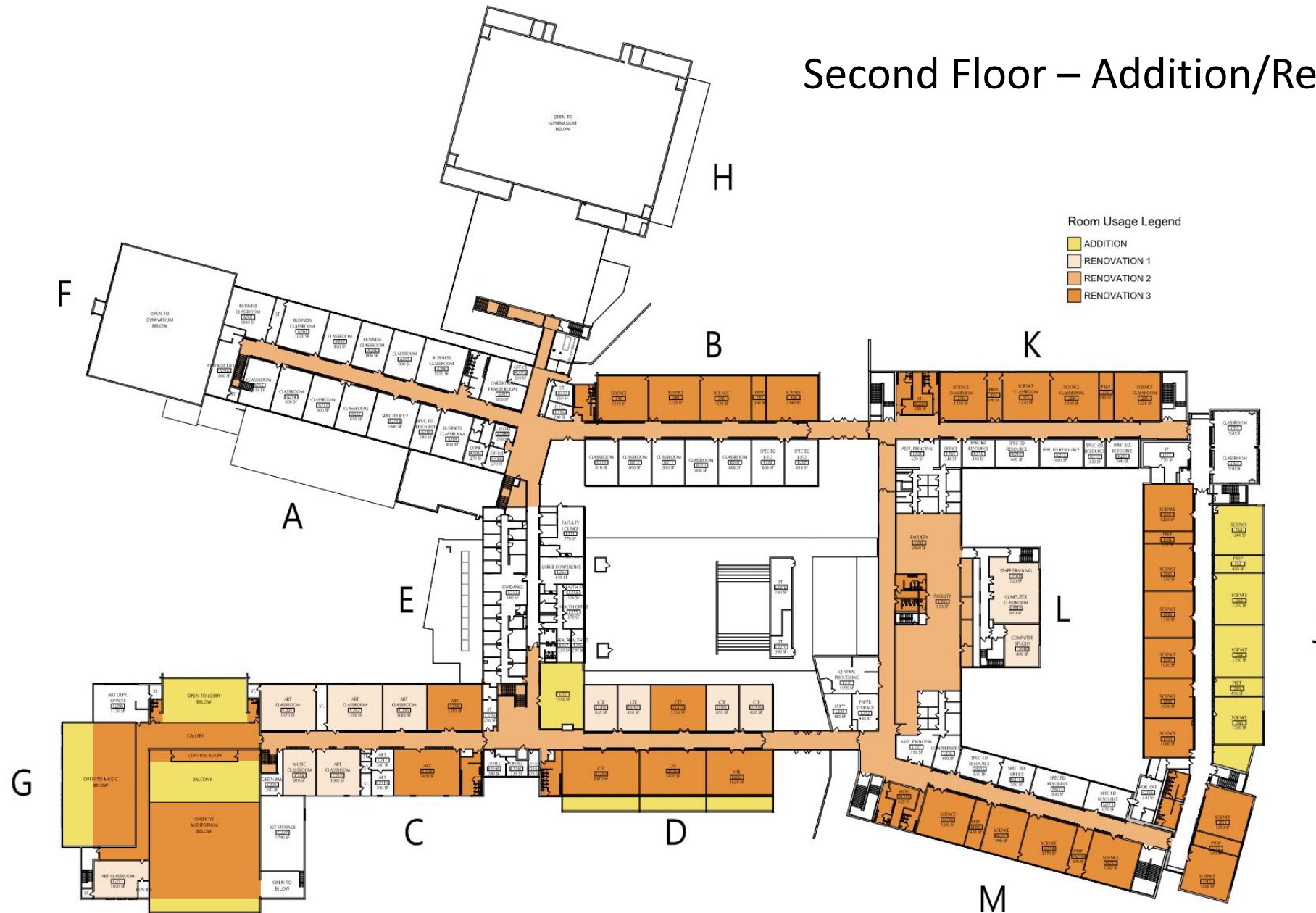

Master Plan Cost – \$182,475,000

## Transfer to Capital



## North Colonie Central School Capital Project

Pre-Referendum Capital Budget (3/5/24)

Item	Description	Building	Cost
<b>Transfer to Capital Project (Vote May 2024)</b>			
T.1	SHS - Refinish Gymnasium Floor	SHS	\$268,320
T.2	District-Wide Radio Replacements (Equipment Purchase)	DW	\$473,304
T.3	SHS Main Storm Drain Replacement	SHS	\$112,944
T.4.1	Resurface Existing Running Track	SHS	\$625,976
T.4.2	Replace Fencing at Running Track	SHS	\$214,760
T.6	SHS Dover Elevator Upgrades	SHS	\$209,456
T.9	Blue Creek ES Cafeteria Abatement Work	BC	\$585,000
T.12	Loudonville ES Music Room - Lead Abatement Project	LO	\$89,544
T.13	Latham Ridge ES Gymnasium Ventilation Project	LR	\$402,584
T.14	Upgrade Basketball Hoops at Elementary Schools	DW	\$456,040
T.15	Water Heater Replacements - (10 total @ \$10,000 each)	DW	\$178,984
T.16	Add Sound Panels at SG, LR, BC Cafeterias	SG   LR   BC	\$161,096
T.17	Loudonville ES Elevator Upgrades	LO	\$204,048
1.5.4	SHS Single Occupancy Bathrooms - D-Wing - Second Floor	SHS	\$536,536
1.5.5	SHS Single Occupancy Bathrooms - C-Wing - Second Floor	SHS	\$536,536
<b>Subtotal:</b>			<b>\$5,060,000</b>

## Referendum Scope of Work



J-Wing Classroom Addition  
 J-Wing Single Occupancy Toilet  
 Renovations  
 Kitchen/Cafeteria Renovations  
 Auditorium Reconstruction  
 Music Rehearsal Space  
 Reconstruction  
 G-Wing Single Occupancy Toilet  
 Renovations

1ST FLOOR

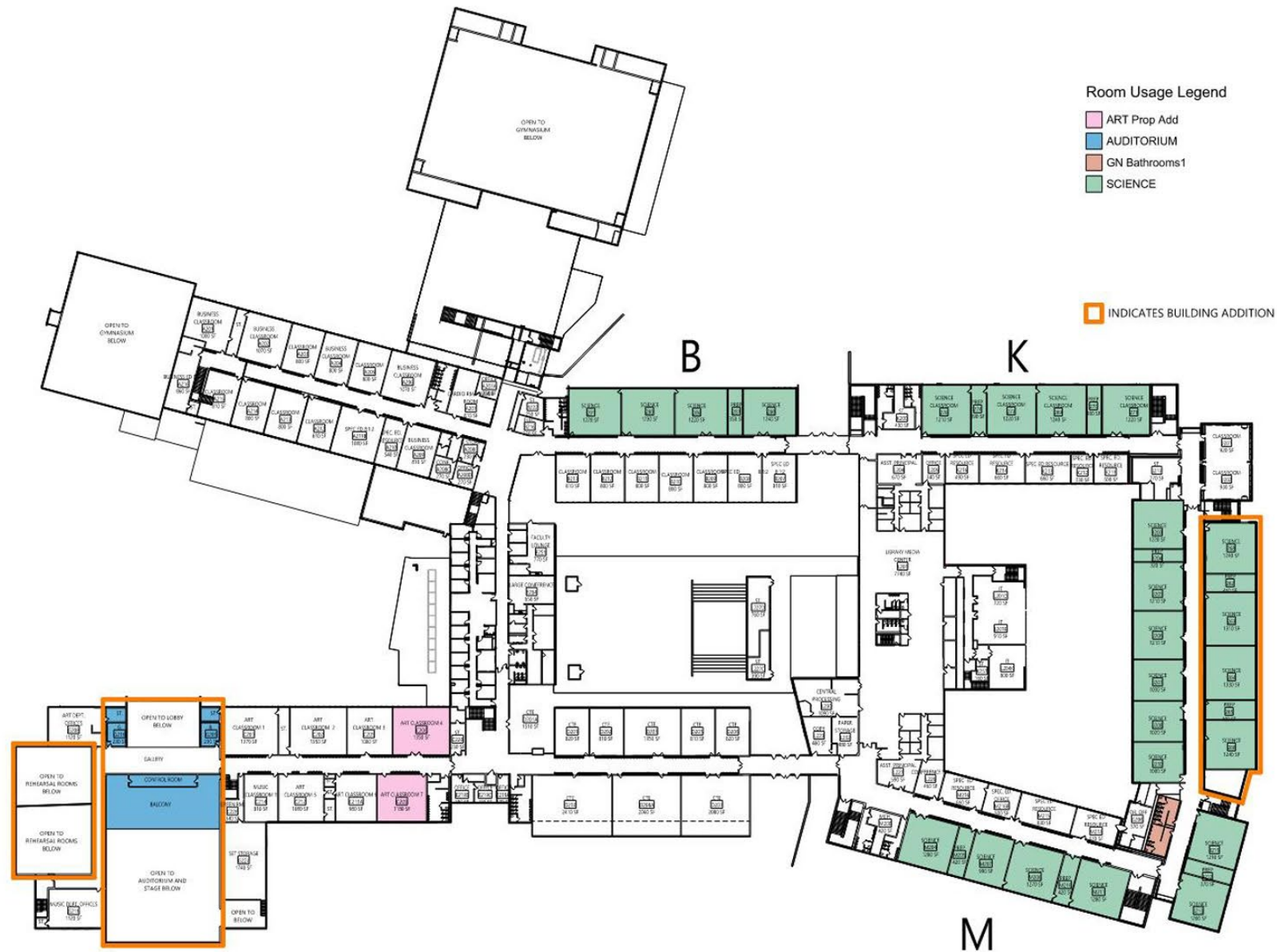

J-Wing Science Labs Addition  
 B, K, J, M Science Renovations  
 J-Wing Single Occupancy Toilet  
 Renovations  
 Kitchen/Cafeteria Renovations  
 Auditorium Balcony  
 Art Gallery Renovations  
 Misc. Roof Replacement

Lower Maloy Synthetic Surface  
Walker Field LED Lighting  
LED Entrance Sign  
HVAC Controls

2ND FLOOR

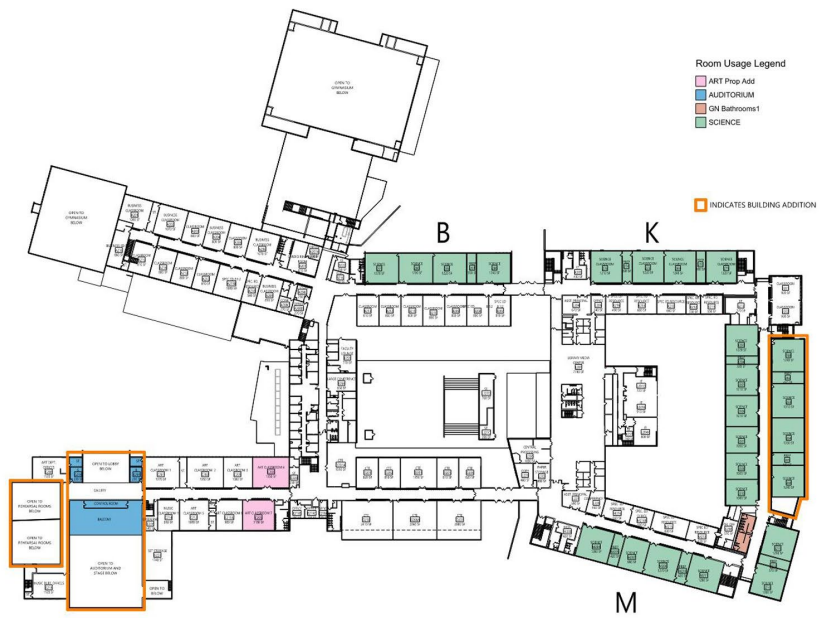

2ND FLOOR



1ST FLOOR

Total Cost— \$94,137,680

# *Scope of Work Summary*

- 2-Story J-wing addition with Science Labs and General Classrooms
- Kitchen/Cafeteria Renovations
- HVAC control systems upgrade
- Single Occupancy Toilet Renovations
- Science and Music/Auditorium
- J and G-Wing Single Occupancy Toilet Renovations
- LED Entrance Sign
- Misc. Roof Replacements
- Lower Maloy Turf Field
- Walker Field Lights
- **\$94.1 Million**

# *Tax Impact Summary*

	Estimated Project Cost	Estimated Building Aid Received	Estimated Building Aid Ratio	Estimated Tax Rate per \$1,000 of Taxable Value	Estimated Tax Impact per \$1,000 of Assessed Value			
					\$100,000	\$170,000	\$300,000	\$500,000
Scope of Work	\$94,137,680	\$73,547,527	78%	\$1.16	\$116	\$197	\$348	\$580

## Questions/Discussion



CSARCH

